

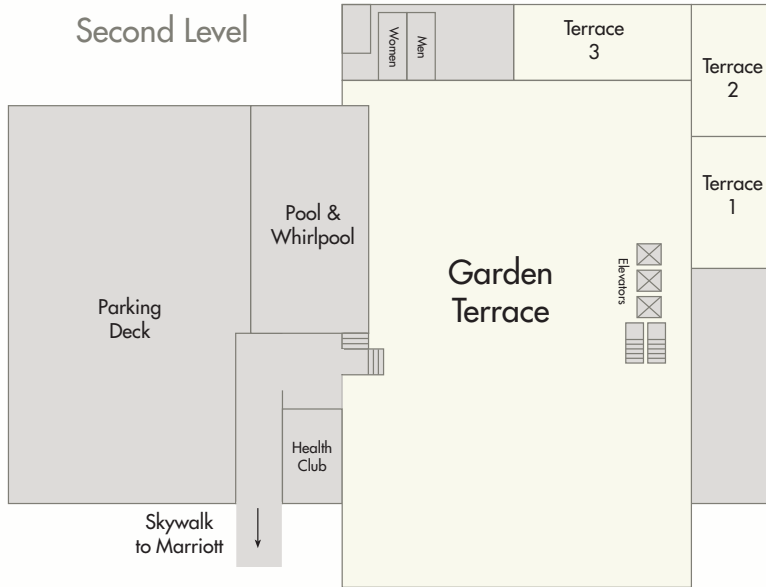

Embassy Suites Conference & Meeting Rooms

Second Level



Fourth Level

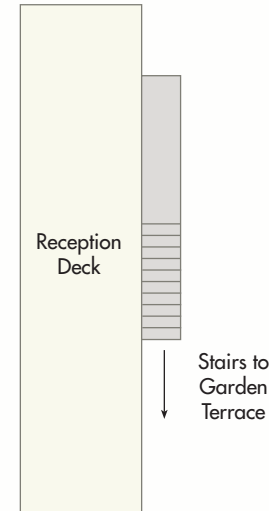

Lower Level

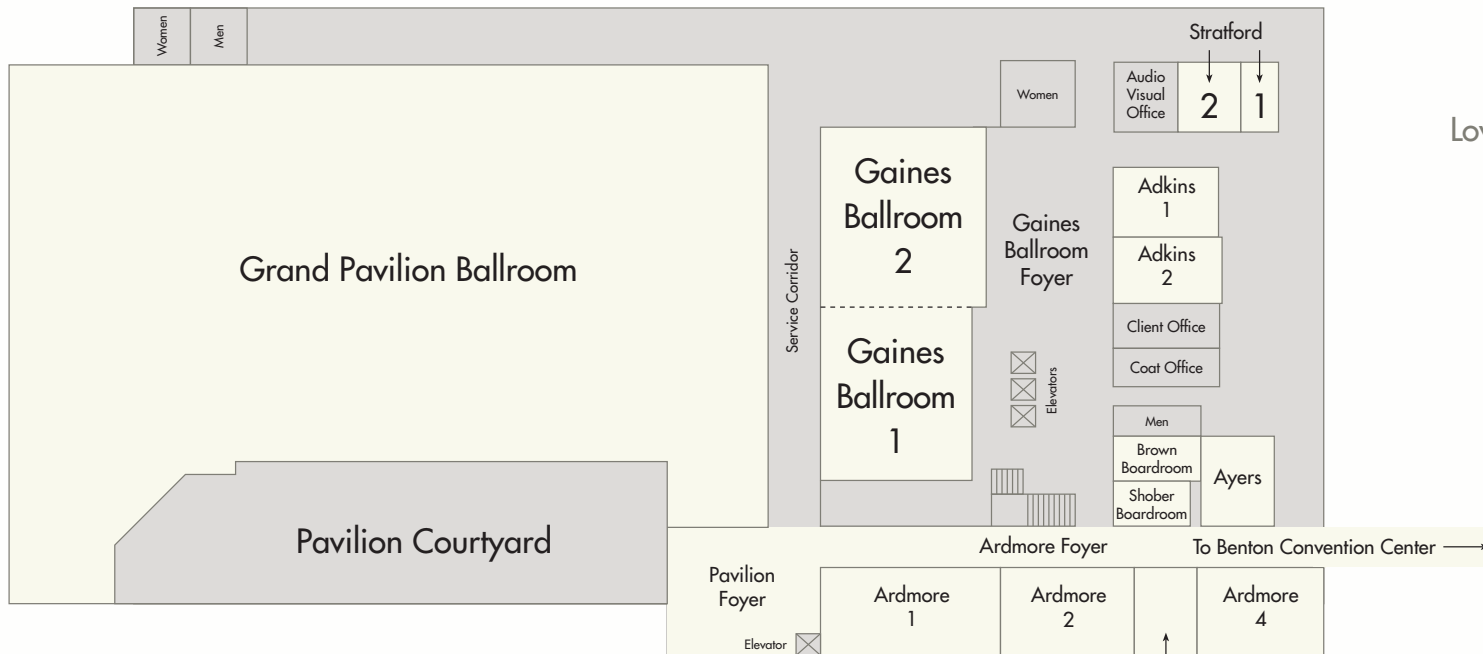



**EMBASSY
SUITES**
by HILTON
Winston Salem

460 N. Cherry Street, Winston-Salem, NC 27101 | Phone: 336.724.2300 | Reservations: 877.888.WSNC | Fax: 336.721.2240 | WinstonSalem.EmbassySuites.com

Embassy Suites Capacity Chart

	DIMENSIONS	SQ. FT.	CEILING	THEATER	CLASSROOM	U-SHAPED	HOLLOW SQUARE	RECEPTION	BANQUET 66" ROUNDS	BOARDROOM	EXHIBITS 8' X 10
Gaines Ballroom	47' x 100'	4,210	10'	375	250	60	80	400	280	-	30
Gaines Ballroom 1	43' x 49'	1,944	10'	150	120	30	30	175	120	-	-
Gaines Ballroom 2	47' x 51'	2,266	10'	150	120	30	30	175	120	-	-
Gaines Ballroom Foyer	36' x 112'	2,400	12'	-	-	-	-	150	-	-	-
Shober Boardroom	13' x 22'	286	10'	-	-	-	-	-	-	10	-
Brown Boardroom	13' x 25'	317	10'	-	-	-	-	-	-	10	-
Atkins 1	20' x 30'	542	10'	30	20	10	10	30	30	-	-
Atkins 2	19' x 31'	546	10'	30	25	15	15	40	40	-	-
Stratford 1	20' x 11'	217	10'	20	10	-	-	15	10	-	-
Stratford 2	20' x 18'	366	10'	25	15	8	10	35	30	-	-
Ardmore 1	25' x 51'	1,231	10'	100	60	35	40	120	80	-	-
Ardmore 2	25' x 38'	922	10'	80	40	25	30	75	60	-	-
Ardmore 3	25' x 18'	402	10'	20	10	-	-	15	20	10	-
Ardmore 4	25' x 36'	762	10'	40	20	15	18	70	60	-	-
Ayers Boardroom	21' x 25'	683	10'	-	-	-	-	-	-	12	-
Ardmore Foyer	12' x 125'	1,500	12'	-	-	-	-	-	-	-	-
Terrace 1	24' x 38'	905	7'	50	40	15	18	60	50	-	-
Terrace 2	24' x 38'	894	8'	50	40	15	18	60	50	-	-
Terrace 3	22' x 51'	1,106	8'	100	50	25	30	100	60	-	-
Grand Pavilion	152' x 214'	24,152	11'	2,000	-	-	-	1,200	900	-	118
Pavilion Courtyard	60' x 136'	3,299	22'	-	-	-	-	300	-	-	-
Pavilion Foyer	42' x 60'	1,659	10'	-	-	-	-	100	-	-	-
Garden Terrace	100' x 145'	8,379	128'	600	-	-	-	600	300	-	-
Reception Deck	33' x 142'	3,665	75'	300	-	-	-	280	200	-	-